

# LOOMINOLOGY

THE HEART OF THE LOOM





### **50 YEARS OF EXPERIENCE**

For years and years, we travel along with our customers, suppliers, and employees together with our LOOMINOLOGY brand in the future...

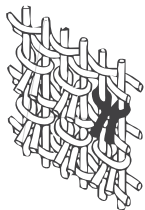

### **EXCELLENT QUALITY**

The designs that our designers have prepared with their creative intelligence, we combine it with the mastery of our craftsmen.

Our love for this accumulation and our work exposes the heritage quality rugs that you may use for many years.



### **WIDE RANGES OF PRODUCT**

- **ORIGINAL TURKISH DOUBLE KNOT RUG PRODUCTION**

We started our Turkish hand-knotted rug weaving adventures in 1963 in Turkey and now extended our production capacity yearly 5000m2 without sacrificing the characteristics of Turkish double knotting system in Turkey, Bangladesh, and India.

- **TIBETIAN WEAVING,**

We carefully choose the most special materials that have the gift of nature to us like silk and wool. Tibetan weaving is one of the best production for custom orders we produce in Nepal.

- **HAND/AUTO TUFT PRODUCTION**

We began to manufacture Autotuft Custom order carpets for residential and commercials five years ago with the experience we have accumulated in hand-knotted rugs production.

We have the capacity around 2000m2 monthly which we make the production in Turkey/Istanbul with high-quality materials.

### **FAST PRODUCTION & DELIVERY**

Due to we produce the orders in-house, the lead time for custom orders is very quick like 4 weeks.



Loominology will be happy to be a partner preparing your current projects with our professional designers, selecting colors and right materials.

We wish you a pleasant business...

## DESIGN SERVICE



Although we are a large collection, we sometimes know that a more unique approach is needed. We encourage our customers to discover their own creativity and create a unique piece perfectly adapted to their personal style. You may customize one of your existing designs or support a completely new design. Our expert team will be delighted to guide you through this exciting process.

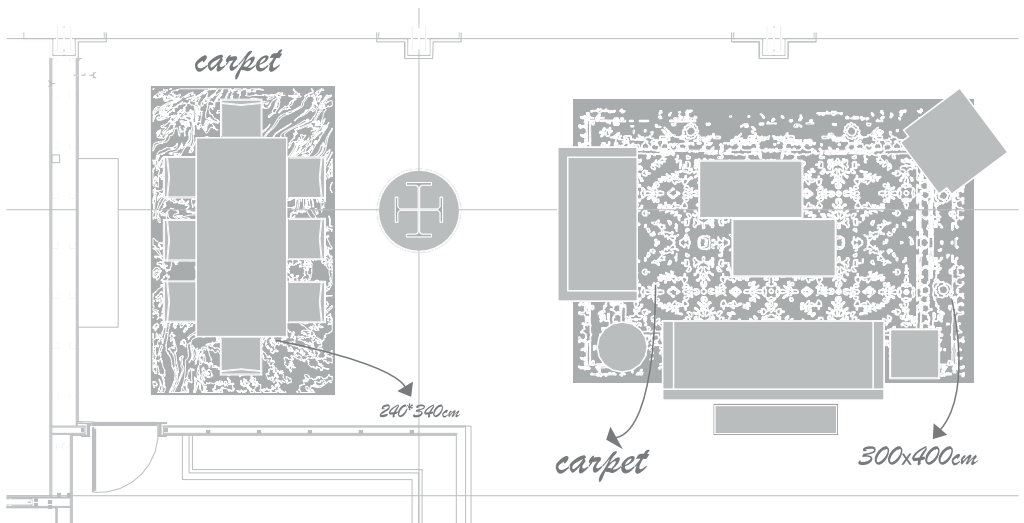



Geo005J Color: Beige



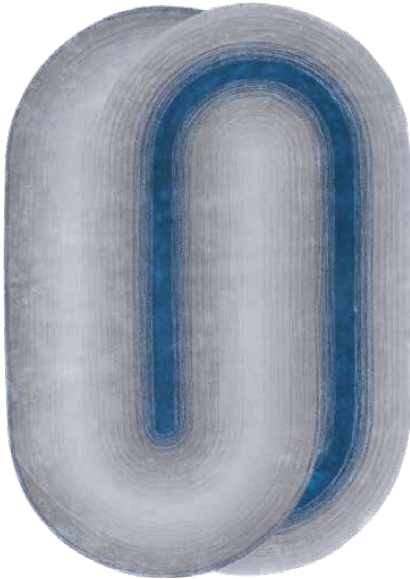

Design: Geo005 Color: J  
Composition: Exclusive Viscose



Design: Geo005 Color: A  
Composition: 100% Viscose



Design: Geo007 Color: J  
Composition: Exclusive Viscose

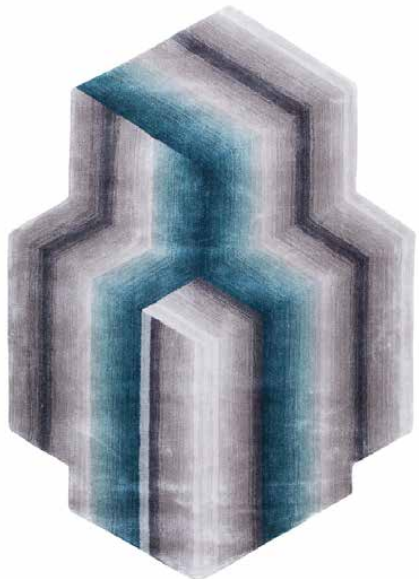

Design: Cascade001 Color: J  
Composition: 100% Viscose



Design: GEO002 Color: D  
Composition: Exclusive Viscose

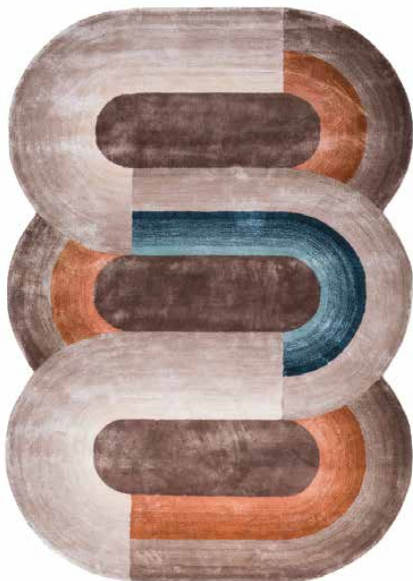

Design: Geo002 Color: N  
Composition: 100% Viscose



Design: Geo002 Color: B  
Composition: 100% Viscose



Design: Geo006 Color: F  
Composition: Exclusive Viscose





Design: Circle001 Color: H  
Composition: 100% Viscose

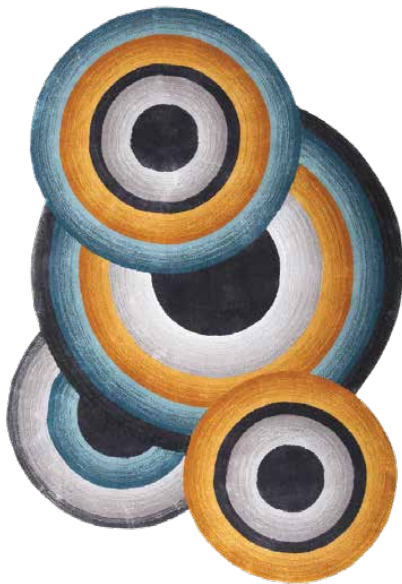

Design: Circle001 Color: J  
Composition: 100% Viscose



Design: Circle 002 Color: N  
Composition: Exclusive Wool & Viscose



Design: Pleat001 Color: A  
Composition: Exclusive Viscose

Newtulip001 Color: G







Design: Newtulip001 Color: G  
Composition: Exclusive Viscose

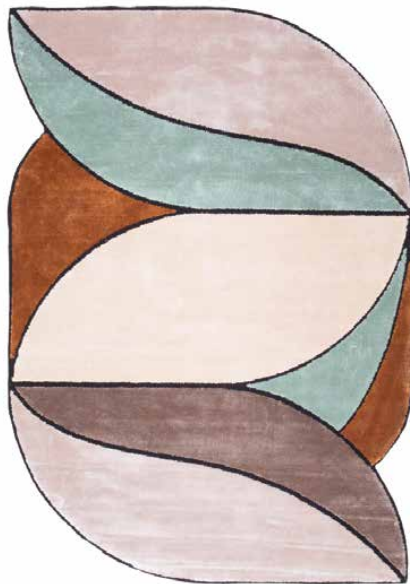

Design: Eye001 Color: C  
Composition: 10% Wool & 90% Viscose



Design: Weave002 Color: G  
Composition: Exclusive Viscose



Design: Weave002 Color: C  
Composition: 100% Viscose

Design: Trace003 Color: Beige







Design: Trace003 Color: Beige  
Composition: 100% Viscose



Design: Trace003 Color: Pearl Gray  
Composition: Exclusive Viscose

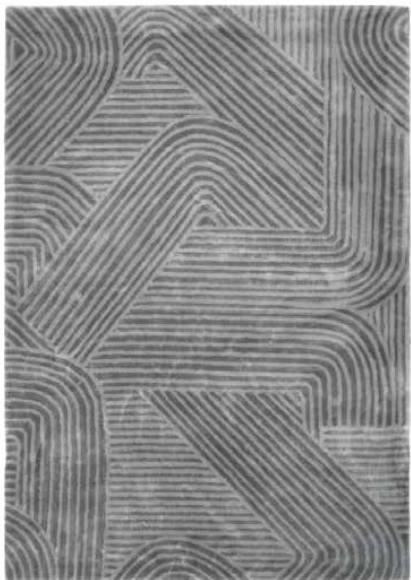

Design: Trace001 Color: Silver  
Composition: 100% Viscose



Design: Trace002 Color: Silver  
Composition: 100% Viscose



Triple003 Color: K





Design: Triple003 Color: K  
Composition: Exclusive Viscose



Design: Triple002 Color: F  
Composition: 100% Viscose



Design: Triple001 Color: A  
Composition: 40% Wool & 60% Viscose



Design: Triple001 Color: F  
Composition: 40% Wool & 60% Viscose





Tiger001 Color: A





Design: Tiger001 Color: A  
Composition: Exclusive Wool & Viscose



Design: Leopard001 Color: D  
Composition: Exclusive Viscose



Design: Leopard002 Color: A  
Composition: Exclusive Viscose





Shinny002 Color: A





Design: Shiny001 Color: J  
Composition: Exclusive Wool & Viscose

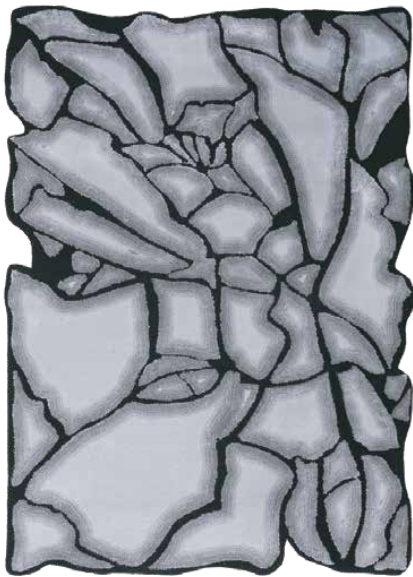

Design: Shiny001 Color: A  
Composition: Exclusive Wool & Viscose

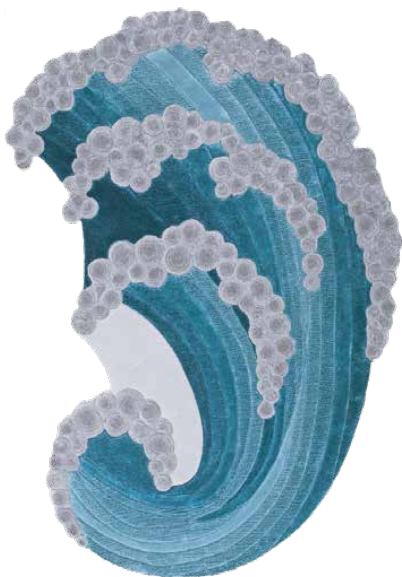

Design: Jewel001 Color: J  
Composition: Exclusive Viscose

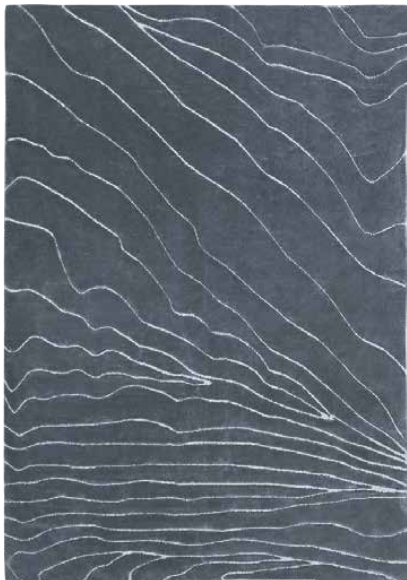

Design: Shiny002 Color: A  
Composition: Exclusive Viscose





Design: Naitulus002 Color: F





Design: Nautilus001 Color: G  
Composition: 100% Viscose



Design: Nautilus002 Color: F  
Composition: Exclusive Viscose



Design: Nautilus001 Color: U  
Composition: 100% Viscose



Design: Pearl001 Color: U  
Composition: 100% Viscose



Brush001 Color: H





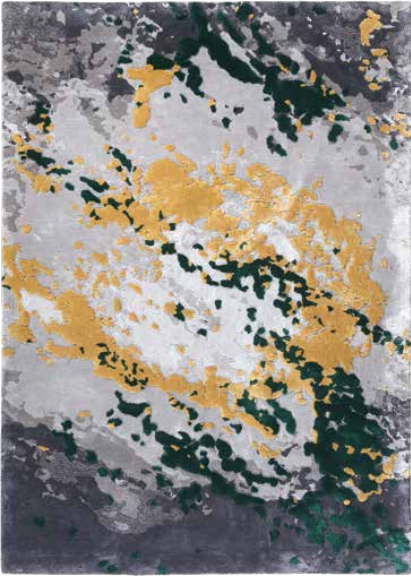

Design: Brush001 Color: H  
Composition: 100% Viscose



Design: Tissues001 Color: Teal  
Composition: 100% Viscose



Design: Tissues002 Color: Anthracite  
Composition: 100% Viscose



Design: Tissues004 Color: Beige  
Composition: 100% Viscose



Design: Marble001 Color: A  
Composition: 100% Viscose



Design: Marble003 Color: M  
Composition: 100% Viscose



Design: Marble004 Color: C  
Composition: 100% Viscose

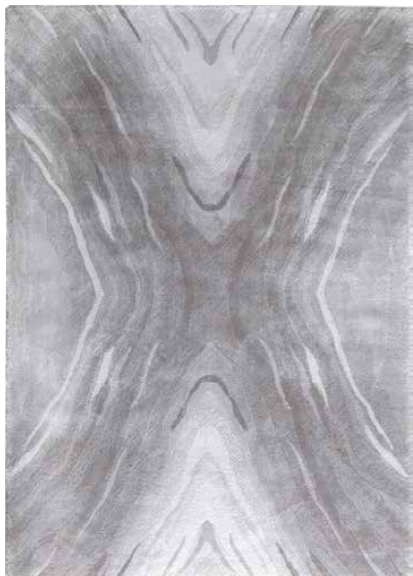

Design: Marble002 Color: D  
Composition: 100% Viscose



## REFERENCE LIST

- Private Villa's Carpets The Ritz-Carlton Residences, Bodrum Mugla Turkey, 2021
- Celebrity Houses in Texas, 2021
- Celebrity Houses in Moscow, 2021
- Tommy Hilfiger, Stores, Turkey, 2020-2021
- Public Area's Carpets Sheraton Hotel Tel Aviv Israel, 2020
- Villa Project, Dallas, 2020
- Private Home, Monaco, 2020
- Penthouse Paris, 2020
- Quadran Stores by Krn Interiors, 2019
- Monaco Residential House, 2019
- Villa Projects at Kazakhstan, Uzbekistan, Qatar, 2019
- Public Area Carpets, Neva Tower, Moscow, Russia, 2019
- Suites and Guestrooms Carpets, Reges Hotel Cesme, Izmir, Turkey, 2019
- Suites and Guestrooms Carpets, Sheraton Hotel, Tel-Aviv, Israel, 2019
- Prayer Room Carpet, Mersin Hilton, Mersin, Turkey, 2019
- Lounge Carpet, Four Seasons Istanbul at The Bosphorus Hotel, Istanbul, Turkey, 2018
- Room Carpet, Reges Hotel Cesme, Izmir, Turkey, 2018
- Presidential Room Carpets, Adana Hilton, Adana, Turkey, 2018
- Presidential Room Carpets, Mersin Hilton, Mersin, Turkey, 2018
- Private Office, Yildiz Palace, Presidency of The Republic of Turkey, Istanbul, Turkey, 2017
- Private Office Carpet, Republic of Turkey Ministry of Foreign Affairs, Ankara, Turkey, 2017
- Residence Mock-Up Rooms Carpets, Federation Tower, Moscow, Russia, 2017
- Lounge Carpet, DoubleTree by Hilton, Istanbul, Turkey, 2017
- Private Office, The Organization Of Islamic Cooperation, Istanbul, Turkey, 2017
- Room Carpet, Hilton Istanbul Bosphorus, Istanbul, Turkey, 2016
- Retail Store Carpets, Damat Tween, Nisantasi, Istanbul, Turkey, 2016
- Residence Carpets, Acar Blue, Istanbul, Turkey, 2016
- Meeting Room Carpet, Swissotel Resort, Bodrum Beach, Bodrum, Istanbul, Turkey, 2015
- Lounge Carpet, Hilton Garden Inn Corlu, Tekirdağ, Turkey, 2015
- Private Area Carpet, Hyatt Regency Istanbul Atakoy, Istanbul, Turkey, 2014
- Private Office Carpets, Headquarters of Turk Telekom, Ankara, Turkey, 2014
- Private Office, Air Force Academy, Turkish Air Force, Istanbul, Turkey, 2013



